

HIGH ACCURACY
HIGH SPEED
HIGH RIGIDITY

PRECISION TSUGAMI



*Combination of Turret and Tool Spindle
Fixed-headstock turning center for realizing high productivity*

CNC Precision Turning Center

TMB2

Applicable to complete machining for complicated parts in one machine

■ Powerful Spindle

High motor output (11/7.5kW) shortens cycle time.

■ High flexibility for various machining

Tool spindle can machine from various directions using Y- and B-axis control.

Complete machining from a bar stock by equipping the back spindle as standard.

■ ATC, tool magazine as standard

Correspond to small production of a large variety workpieces by ATC and Tool magazine.

■ Shortened cycle time by simultaneous marching of both turret and tool spindle

Enabling simultaneous machining of the both end faces of front and back and 2-point external turning.

■ Minimal thermal displacement of X axis (diametrical axis)

The diametrical axis (X axis) of the turret and the tool spindle is arranged in parallel to the ground, and the influence on machining accuracy by thermal displacement becomes minimal.

■ Machining-center-level powerful milling capability

The 5.5kW high-power built-in motor enables machining-center-level heavy-duty milling.



Machine Standard Specifications

Item	TMB2	
Machining range	Max.machinable dia.	φ51mm
	Max.main spindle speed	6,000min ⁻¹
Spindle Motor	Output (built-in)	11/7.5kW
	Main spindle Indexing angle	0.001°
	Type	1 spindle with ATC
Tool Post	B axis indexing angle/ Minimum indexing angle	-15°to 195°/0.001°
	Tool spindle indexing angle/position	90°/4 pos.
	Max.spindle speed	10,000min ⁻¹
	Motor output (built in)	5.5/2.2kW
Turret	Number of Turret	16 position
	Tool size	□20mmX125mm
	Sleeve size for drill holder	φ32mm
	Index drive	Servo motor
Back Spindle	Spindle speed	6,000min ⁻¹
	Motor output (built in)	11/7.5kW
	Main spindle indexing angle	0.001°
Stroke	X1 axis	380mm
	Y1 axis	110mm(±55mm)
	Z1 axis	560mm+135mm
	X2 axis	130mm
	Z2 axis	800mm
	A2 axis	800mm
Feedrate	A2,Z1,Z2 axes	40m/min
	X1,Y1,X2 axes	24m/min
ATC	Tool shank shape	Sandvik Coromant C4
	Max.tool size	φ80mm X 150mm(4kg)
	Number of tool storage	30 (Option 60,118)
	ATC time (tool to tool)	0.8sec
Power source	Net weight	8,000kg
	Electric power requirement	40KVA
	Compressed air requirement	0.5MPa
	Air discharge rate	300NL/min
WidthxDepthxHeight	3,650x2,200x2,245mm	

NC Standard Specifications

NC unit	FANUC 18i-TB
LCD/MDI	10.4" color LCD
Manual pulse generator	1
I/O interface	Modem card, memory card can connect
Parts program storage length	80m
Number of registered program	63
Back ground editing	
Tool radius compensation R	
Programable data input	
Work coordinate system setting	
Conversion to 3D coordinates	
Cs contour control	Main, Back spindle
Canned cycle	
Multiple repetitive cycle	
Canned cycle for drilling	
Number of tool offsets	64(30T) 99(60T)
Tool geometry wear offset	
Rigid tapping	
Reference position return	
Single block	
Optional block skip	
Dry run	

NC Option

Parts program storage length	160 , 320 , 640 , 1280m
Registered number of program	200 , 400 , 1000
Extended parts program editing function	
Number of tool offsets	400 , 999 pairs
3D rigid tapping	for inclined plane
Herical interpolation	for large dia,screw and solid cam
Polar coordinate interpolation	

Standard Accessories

Standard tool set
Transit clamps
Main spindle chuck(SAD50)
Back spindle chuck(SAD50)
Tool clamper
B axis indexing angle 0.001°
Front door interlock
Tool magazine door interlock
Back cover interlock
Coolant oil flow switch
Reinforced safety window glass

Optional Accessories

60 pcs tool magazine
118 pcs tool magazine
Bar feeder interface
Hobbing specification
Workpiece unloader
Workpiece conveyor
Parts catcher
Ejector
Chip conveyor
Mist collector
Dumper for fire
Automatic fire extinguisher
Signal tower
Tool checker
Scale specification
Collet chuck (main/back spindle)
Drill holder

Tooling Zone

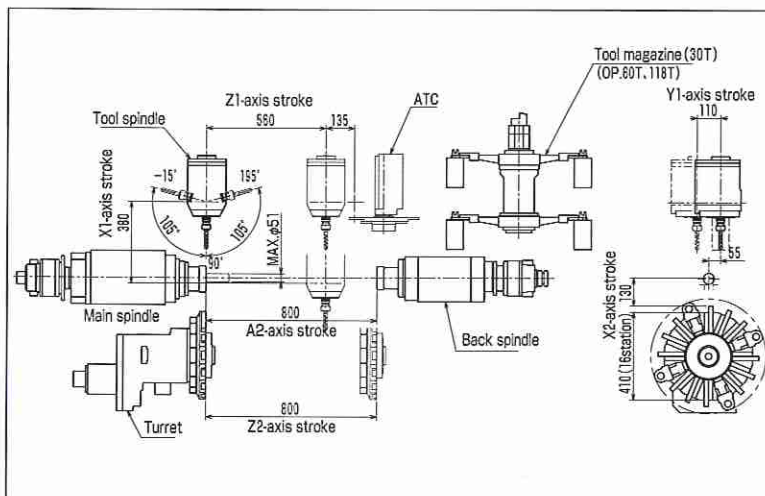

Appearance

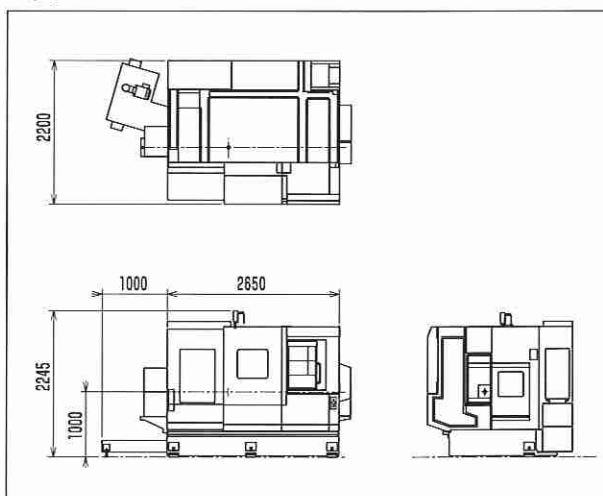

The export of this product is subject to an authorization from the government of the exporting country and/or Japan. Check with the government agency for authorization.

The specifications of this catalogue are subject to change without prior notice.

 **TSUGAMI CORPORATION**

1-9-10, Horidome-cho, Nihonbashi, Chuo-ku,
Tokyo, 103-0012, JAPAN
Phone : 03-3808-1172
Facsimile : 03-3808-1175